

↑ ARBO MASTER

Fully adjustable work positioning harness with a unique motion system at front attachment points, specially invented for professional arborists allowing freedom of movement at the tree top.

DESCRIPTION

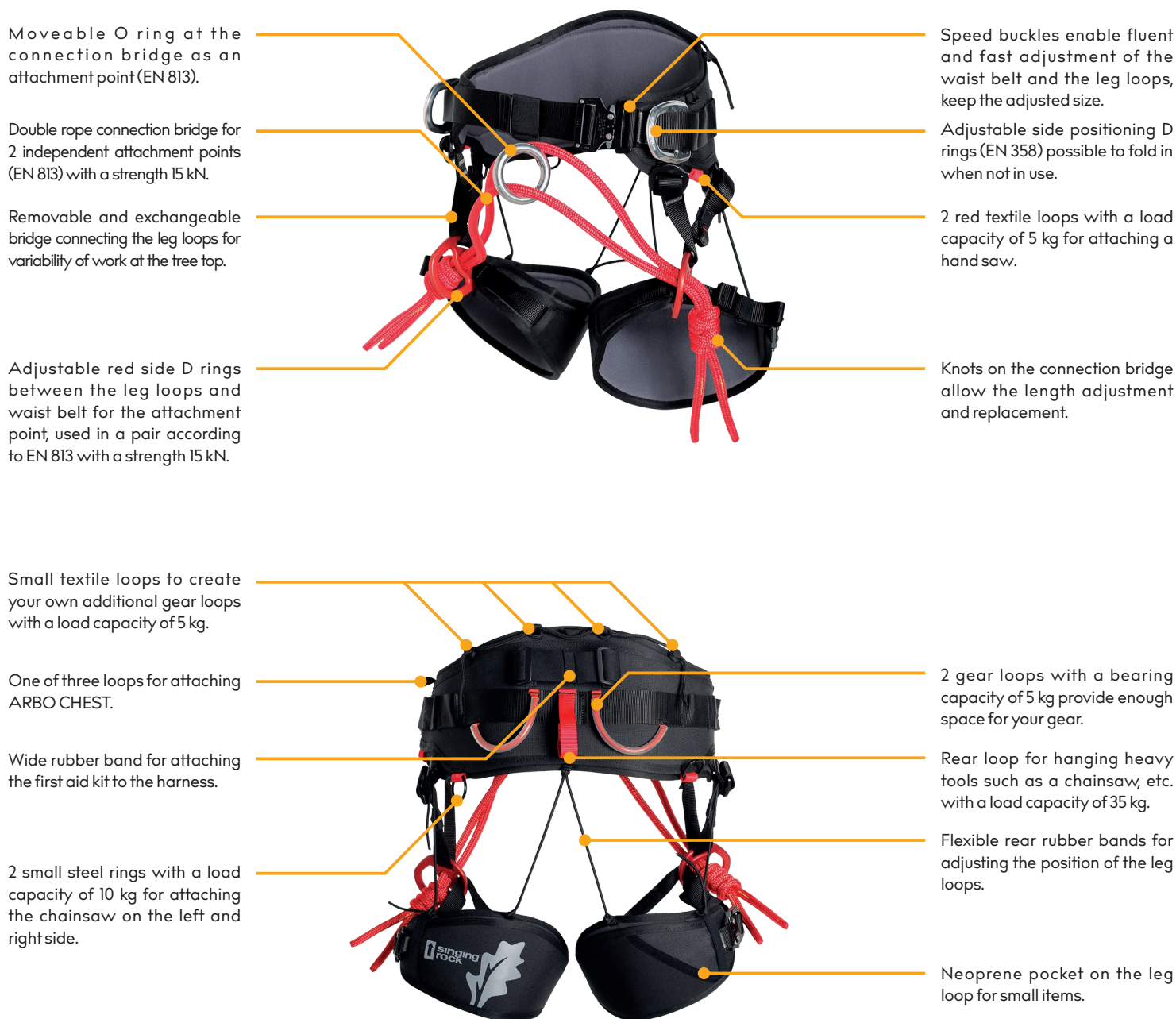

KEY FEATURES

- double rope connection bridge with the moveable O ring
- neoprene pocket on the leg loop
- loops to attach the chest harness

STANDARDS

CE 1019

EN 358

EN 813

FEATURES



120 kg



1680 g / 59.3 oz (S/M/L)
1760 g / 62 oz (XL)



3 years warranty

MATERIALS



- 21 % PAD
- 20 % light alloy
- 19 % PES
- 15 % PE
- 11 % EVA foam
- 10 % steel
- 2 % PP
- 1 % TPU
- 1 % elastane

TECHNICAL DATA

SPEED buckle

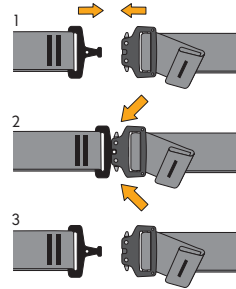

threading through buckle

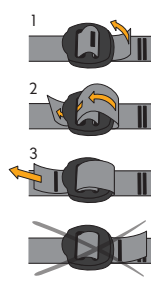

Loops at the waist belt for the possibility of attaching a chest harness.

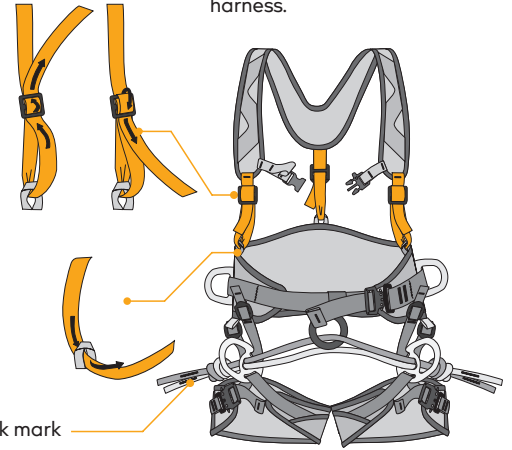

TECHNICAL DATA

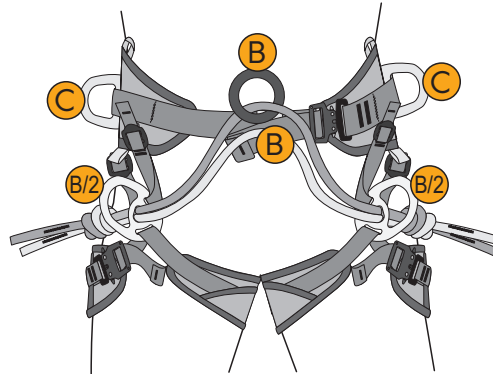
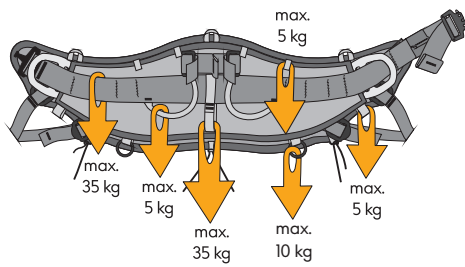

B EN 813:08

C EN 358:18

SIZE CHART



| | S/M/L | XL |
|-----------|----------------|----------------|
| A [cm/in] | 65-100 / 25-39 | 85-130 / 33-51 |
| B [cm/in] | 45-65 / 18-25 | 55-75 / 22-29 |
| M [g] | 1680 | 1760 |

MAINTENANCE

Lifetime of this product depends on the frequency and the environment (salt, sand, moisture, chemicals, etc.) in which is used. Without taking wear or mechanical damage into account and in compliance with the conditions specified in the instructions for use this product may be used 15 years from the date of production and 10 years from the date of the first use.

However mechanical damage can occur during the first use, which can limit the lifetime of this products only to its first use.



beware of salt



beware of UV



beware of chemicals



washing



drying



read instructions

OTHER VIEWS



BACK VIEW: Wide rubber band for attaching the first aid kit to the harness. Neoprene pocket on the leg loop for small items.



SIDE VIEW: Slots for PORTER tool holder to carry your industrial tools.



COMPARISON

ARBO MASTER - TIMBER 3D

- double rope connection bridge for two independent attachment points
- removable and exchangeable bridge connecting the leg loops for variability of work
- adjustable red side D rings between the leg loops and waist belt for the attachment point
- replaceable adjusting webbing for D rings
- improved waist belt ergonomics, wide comfortable waist belt
- 180 g lighter (size S/M/L)
- improved first aid kit attachment system
- possibility of attaching a chest harness



TIMBER 3D

RELATED PRODUCTS



ARBO CHEST
W0108BR00

STANDARDS

-

WEIGHT

160 g